







PROJECT		REF		REV	ITEM CODE	
LOCATION		DATE			PAGE	

## SANITARY WARE SPECIFICATION SHEET

Item Descriptions	GROHE (Germany) "Concetto" Chrome plated 3/8" single-lever sink mixer; nominated flow rate <b>4.5 L/min</b> in WELS Grade 1; Registration No. TM 21-0125	<p>Illustration/ Drawing</p>     
Dimensions	L224 x W118 x H354 mm	
Model	32661003	
Finish / Material	Chrome Plated	
Country of origin	Germany	
Manufacturer	GROHE Limited	
Supplier	Acme Sanitary Ware Co. Ltd Mr. Eric Wong/ Mr. Don Yuen	
Contact Tel/Fax E-mail Website	(852) 2388-7171 / (852) 2710-8012 acme@acmesanitary.com.hk www.acmesanitary.com.hk	

### "Concetto" Single-lever sink mixer 1/2"

- high spout
- monobloc installation
- **GROHE StarLight** chrome finish
- **GROHE SilkMove** 35 mm ceramic cartridge
- **GROHE Zero** isolated inner water ways - lead and nickel free within the tap
- mousseur
- adjustable flow rate limiter
- swivel tubular spout
- selectable swivel area : 0° / 150°
- flexible connection hoses
- **GROHE FastFixation** rapid installation system



32661DC3

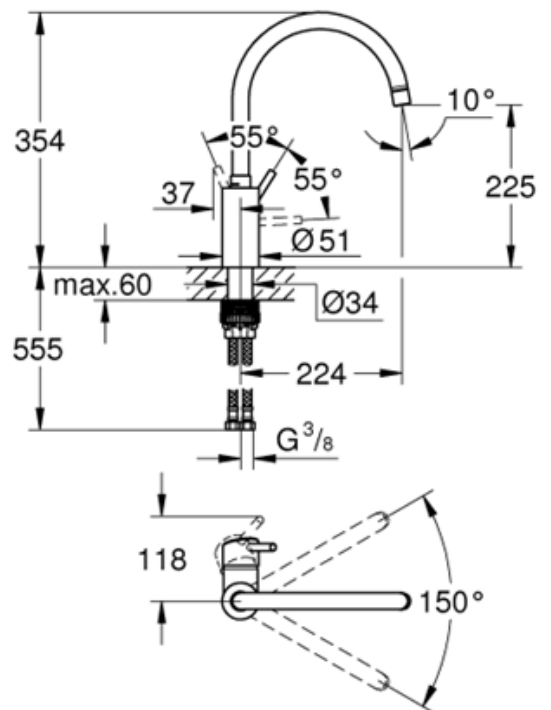

#### Colour options:

- 001 | StarLight Chrome
- DC1 | SuperSteel

Note:

\* All information of the above is for the reference only. No prior notice is made if any changes.

註冊號碼 (Registration No.): TM 21-0125



自願參與用水效益標籤計劃 - 水龍頭  
Voluntary Water Efficiency Labelling Scheme - Water Taps



茲證明  
This is to certify that

將下列水龍頭在本計劃內註冊：  
has registered the following water tap under this scheme :

牌子 / Brand	:	Grohe
型號 / Model	:	32661XX3 + 402749040
種類 / Type	:	Mixing
原產地 / Country or Region Origin	:	Portugal (Mixer) Germany (Flow Controller)

XX – denotes the code of colour

在用水效益標籤上展示的標誌 <i>Symbolic Presentation on the Water Efficiency Label</i>	:	 滴水點 <i>Water droplet(s)</i>
用水效益級別 <i>Water Efficiency Grade</i>	:	1
耗水量 <i>Water Consumption</i>	:	4.5 公升/分鐘 <i>litres/minute</i>

簽發日期：  
Date of Issue: 21 May 2021

 水務署  
Water Supplies Department



水務署署長(張業駒代行)  
for Director of Water Supplies



Waterworks Department

道七號入境事務大樓 48 樓

43/F, Immigration Tower, 7 Gloucester Road, Wan Chai, Hong Kong

本署檔號 : (4) in WSD 3321/2020 T/J(354/2020)  
Our ref.  
來函檔號 :  
Your ref.

電話 :  
Tel.  
傳真 : 2824 0578  
Fax.

26 August 2020



### Approval of "GROHE" Sink Mixer (General Acceptance No. C20200710)

Your letters ref. WRC/2169 and C-WSD/0612 dated 6 April 2020 and 7 July 2020 respectively refer.

Having considered the test reports ref. J24607Ar2 and J24850-1 issued on 16 June 2020 and 3 July 2020 by Nutek Systems (HK) Ltd., this Authority accepts that the fitting described below complies with, and its use when correctly installed does not contravene, the Waterworks Ordinance and Regulations.

**Name of Manufacturer:** Grohe AG  
**Country of Origin:** Portugal  
**Brand:** Grohe  
**Details of Fitting:** 3/8" Single lever sink mixer with 1 no. of flexible hose  
**Model:** 32661XX3  
(where the digits "XX" denote the code of colour)  
**Body Markings:** **GROHE**  
  
**Expiry Date:** 26 August 2024



香港環境保護署  
Environmental Protection Department



10 years  
同心關照  
caring organisation  
Approved by the Government of the Hong Kong  
Special Administrative Region  
16/11/2010-15/11/2020

This Authority hereby permits the use of the above fitting in fresh water plumbing systems subject to full adherence to Waterworks installation requirements. In particular, you are required to draw your customers' attention to the following requirement-

"The cold water supply to the fitting shall be drawn from the same source that supplies the hot water apparatus so as to provide a balanced pressure and to obviate the risk of scalding in the event of a restriction or failure in the water supply."

A condition of this acceptance is that the fitting to be installed shall be replicas of the sample as certified by the testing agent mentioned above and without modifications. This acceptance may be withdrawn at any time if the standard of the fitting installed fails to meet that of the approved sample or if the fitting is found to be unsuitable for use in fresh water plumbing systems.

This acceptance is only applicable to the main body of the fitting, unless otherwise specified.

For the use of the fitting in any project, the General Acceptance Number of this letter must be quoted as a means of identification of acceptance of the fitting by this Authority.

Should you have any enquiries, please contact our Engineer Mr. Terry KUNG at tel. no. 3583 4086.

Yours faithfully,



(CHAN Chung-kun)

for Director of Water Supplies

Encl.

c.c. WSD 3321/1/82 ] - without catalogue  
ME/MC ] - with soft copy only